

# ADDITIONAL INFORMATION

HTG prides itself on making the owner's priorities our priorities. For this project we understand that the top priority is meeting the program needs of the City as well as the Rogers Youth Hockey Association in as efficient manner as possible to keep the project inline with the project budget. That effort starts with the layout of the building and making the plan and layout as efficient as possible. Attached you will find two layout options where we looked at "tightening up" the plan. Saving SF saves cost. This is just the first step - where its layouts, mechanical systems, or other design considerations, our goal is to present you options and information so you can make the best informed decisions.





DATE	NO.



HTG OPTION ONE	
MAIN LEVEL	34,380 SF
MEZZANINE LEVEL -	6,750 SF
TOTAL	41,130 SF

ADVANTAGES:  
ALMOST 15% REDUCTION IN BUILDING  
FOOTPRINT FROM CURRENT PREFERRED  
OPTION\*.  
MAINTAINS PROGRAM REQUIREMENTS

\*CURRENT PREFERRED OPTION BASED ON THE RFP INFORMATION HAS A  
RINK BUILDING OF 40,117 SF WITH FUTURE EXPANSION OF 7,000 - 8,000 SF.

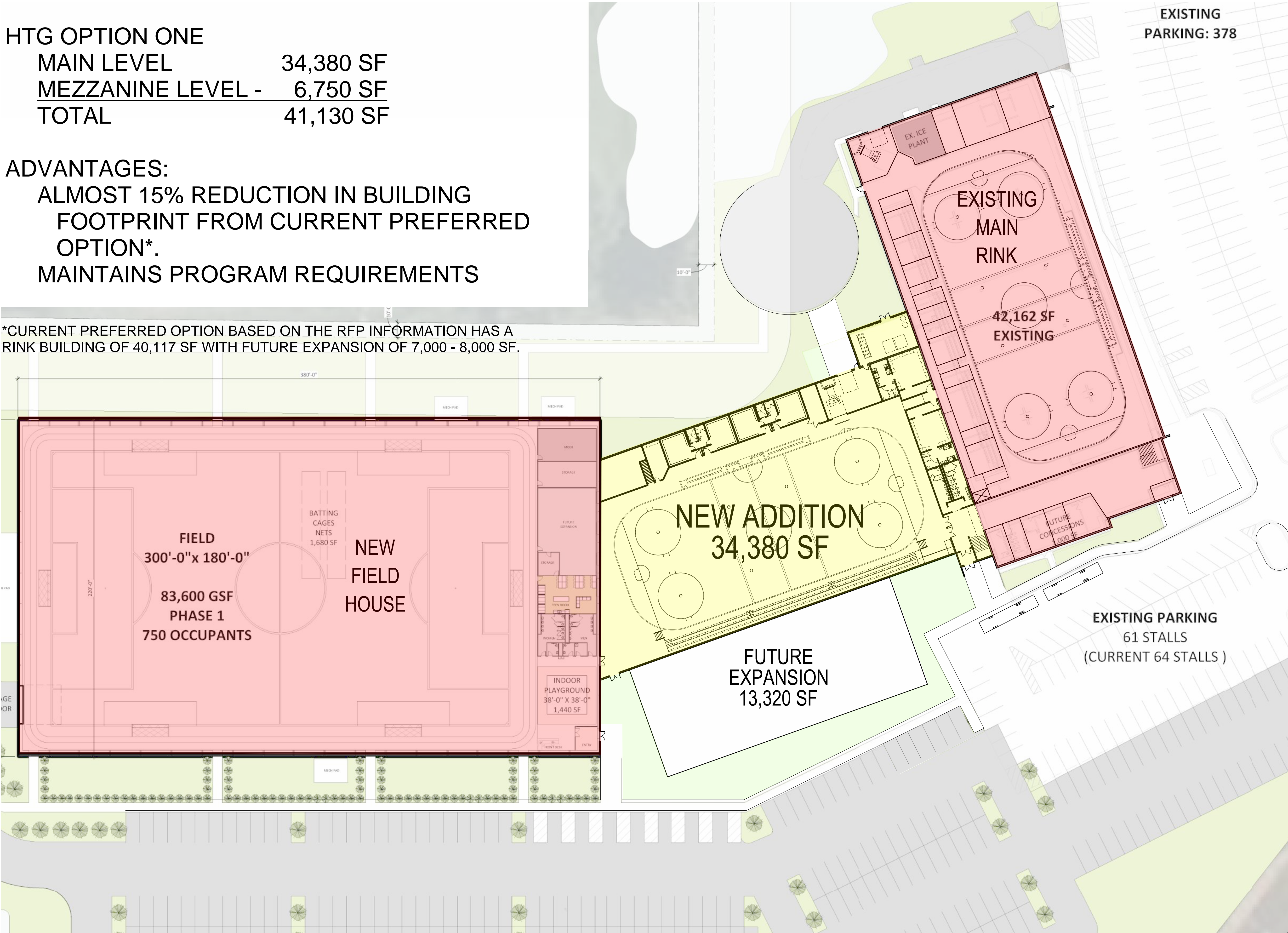



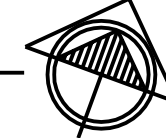





HTG OPTION TWO

MAIN LEVEL	33,720 SF
MEZZANINE LEVEL -	6,940 SF
TOTAL	40,660 SF

ADVANTAGES:

- 16% REDUCTION IN BUILDING FOOTPRINT FROM CURRENT PREFERRED OPTION\*.
- MAINTAINS PROGRAM REQUIREMENTS
- ADDS RYHA OFFICE AND MEETING ROOM
- LESS CONNECTIONS TO EXISTING BUILDINGS
- MORE SPACE FOR FUTURE PROJECTS ON SITE

\*CURRENT PREFERRED OPTION BASED ON THE RFP INFORMATION HAS A RINK BUILDING OF 40,117 SF WITH FUTURE EXPANSION OF 7,000 - 8,000 SF.

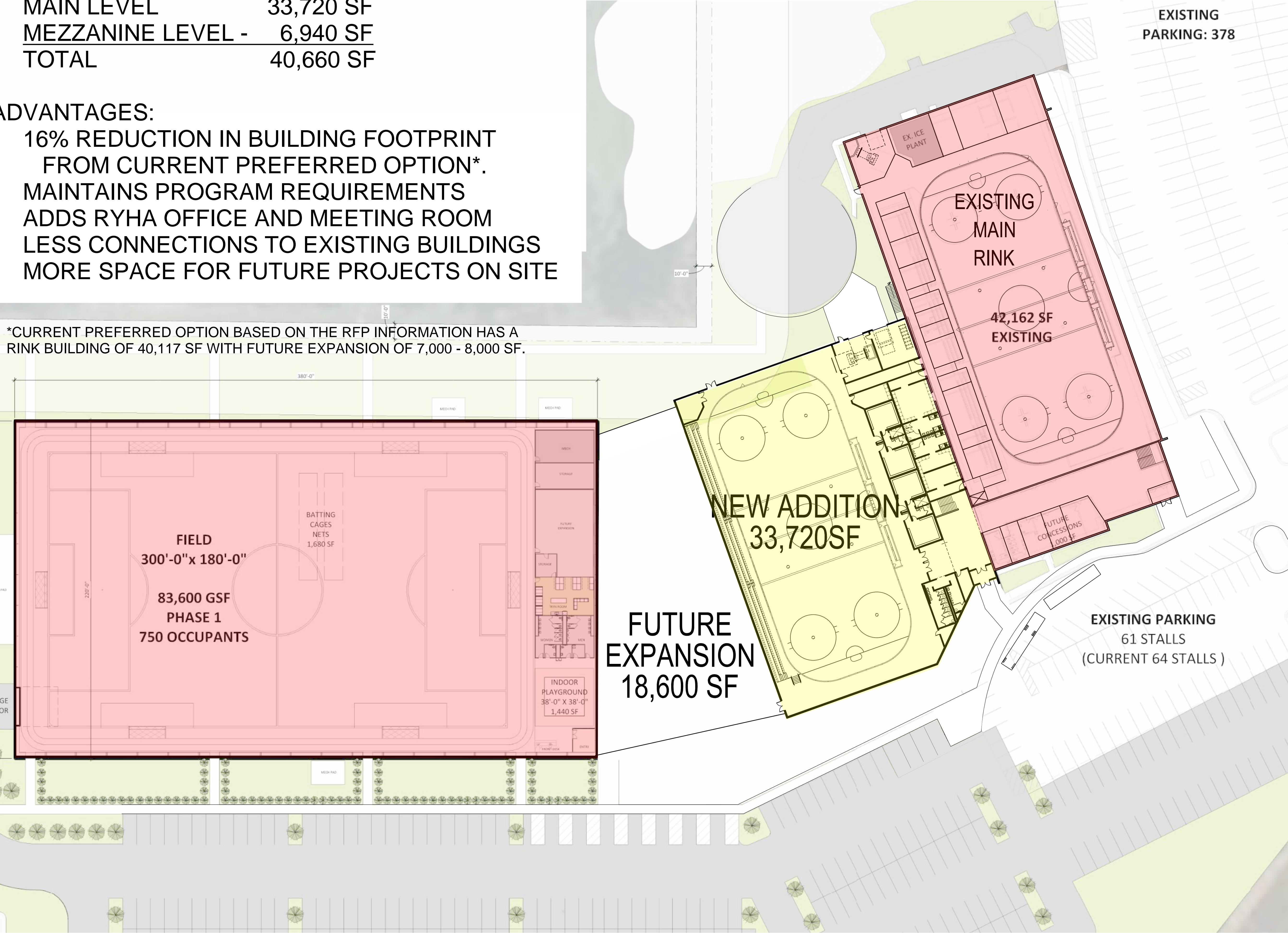

www.htg-architects.com  
Minneapolis Bismarck

9300 Hennepin Town Road  
Minneapolis, MN 55347  
Tel: 952.278.8880

PROJECT

ROGERS ACTIVITY  
CENTER ADDITION



ISSUED SET 08-29-24 CONCEPT SET  
REVISIONS

DATE	NO.

I HEREBY CERTIFY THAT THIS PLAN, SPECIFICATION  
OR REPORT WAS PREPARED BY ME OR UNDER MY  
DIRECT SUPERVISION, AND THAT I AM A DULY  
LICENSED ARCHITECT UNDER THE LAWS OF THE  
STATE OF MINNESOTA

# REG. NO. DATE



OPTION TWO  
SITE PLAN

DRAWN BY: AAT CHECKED BY: TRM

A2.0

ML-151204  
COPYRIGHT © BY HTG ARCHITECTS

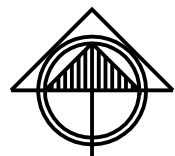



## PROJECT

[illegible]

I HEREBY CERTIFY THAT THIS PLAN, SPECIFICATION  
OR REPORT WAS PREPARED BY ME OR UNDER MY  
DIRECT SUPERVISION, AND THAT I AM A DULY  
LICENSED ARCHITECT UNDER THE LAWS OF THE  
STATE OF MINNESOTA

REG. NO. \_\_\_\_\_ DATE \_\_\_\_\_



OPTION ONE  
FLOOR PLAN  
MAIN LEVEL

DRAWN BY: AAT                      CHECKED BY: TRM

## A2.1

ML-151204  
COPYRIGHT © BY HTG ARCHITECTS

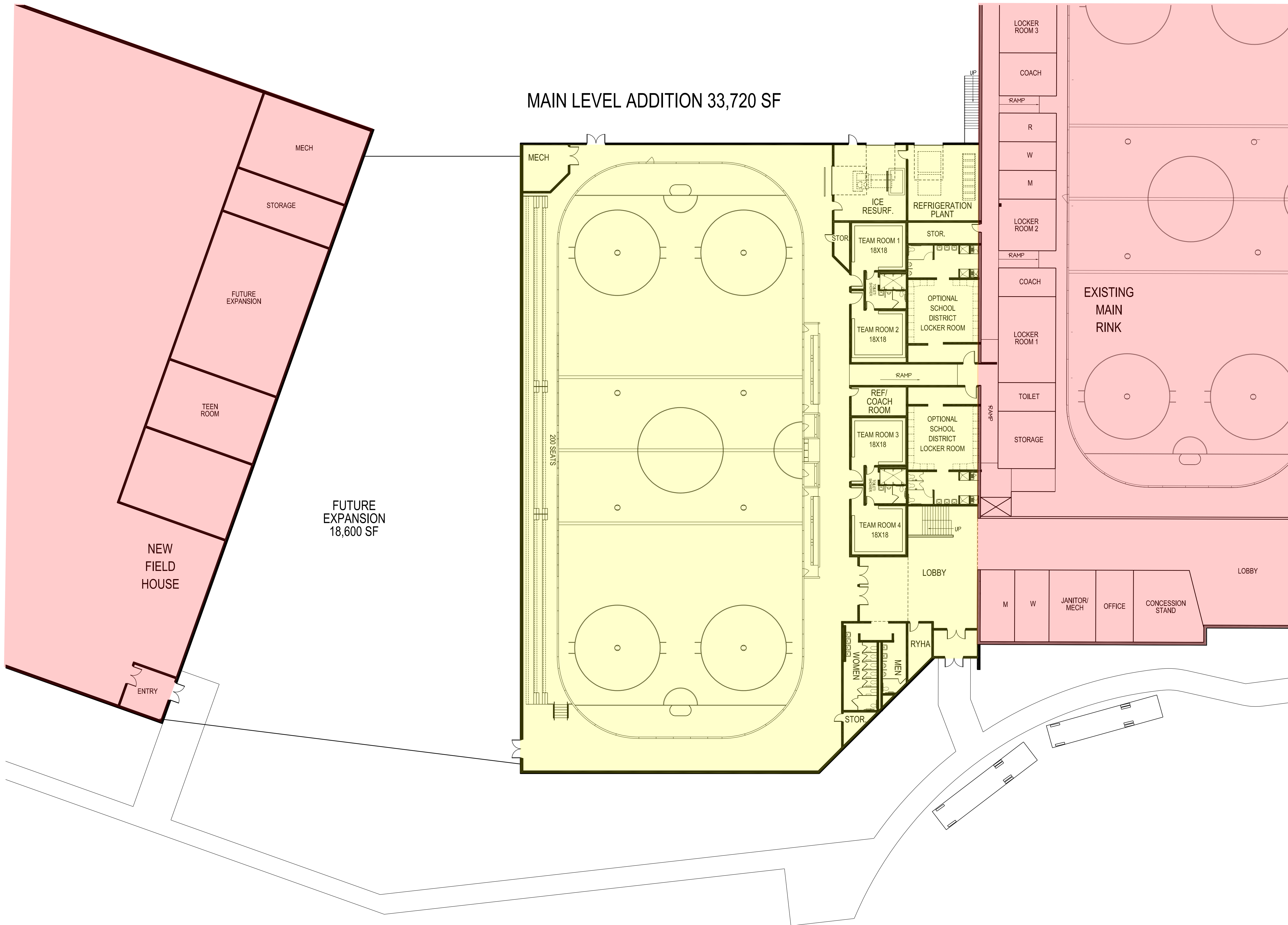

FLOOR PLAN - OPTION ONE - MAIN LEVEL

